

Potential applications:

Widely used in lighting control, heating control, office appliances,

Fire protection system and other automation fields are suitable for chemical, coal, ceramics

For explosion - proof, dust - proof, corrosion - proof and other extreme harsh environment.

- Rated load current 10A to 40A
- Clamshell bolt protection for easier maintenance
- LED input status indicator light
- Ac/dc control optional
- Compliance with CE RoHS

The product selection

BSC	20	12	D	032	Z
Series code	Load current	Load voltage	Input DC	input voltage	zero conduction

Specific models listed in the table below shall prevail

describe	model	Load voltage	Load current
random	BSC2012D032	12—250VDC	20A
zero conduction	BSC2012D032Z	12—250VDC	20A

Technical parameters
input parameters:

Input voltage range	DC 3~32VDC
Input current range	DC 32VDC
Make sure the voltage is on	DC 6~25mA
Make sure to turn off the voltage	DC 3VDC
Reverse voltage	DC 3VDC
Starting current	≤7mA

Output parameters:

Rated load voltage	12:12~250VDC
Rated load current	20A
Transient peak withstand	12:400VDC
Off state leakage current	DC $\leq 5\text{mA}$
State pressure drop	DC $\leq 1.2\text{VDC}$
On and off time	$\leq 5\text{ms}$

other parameters:

Medium pressure	$\geq 2500\text{VAC}$
Insulation resistance	500M Ω 500VDC
Housing material safety gauge	UL94-V0
Substrate materials	aluminum
Working temperature	- 30 $^{\circ}\text{C}$ ~80 $^{\circ}\text{C}$
Storage temperature	- 30 $^{\circ}\text{C}$ ~125 $^{\circ}\text{C}$
Maximum operating humidity	85% no condensation
installation	Panel bolt mounting
weight of the	$\approx 95\text{g}$

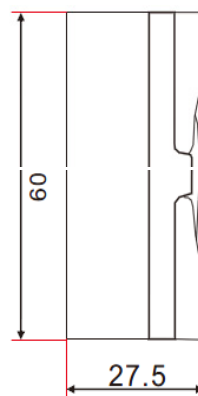
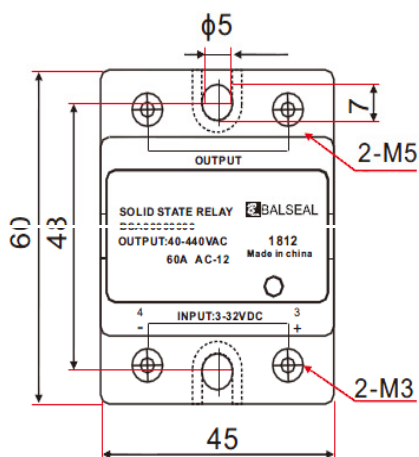
BSC DC output Series

BSC DC output Series

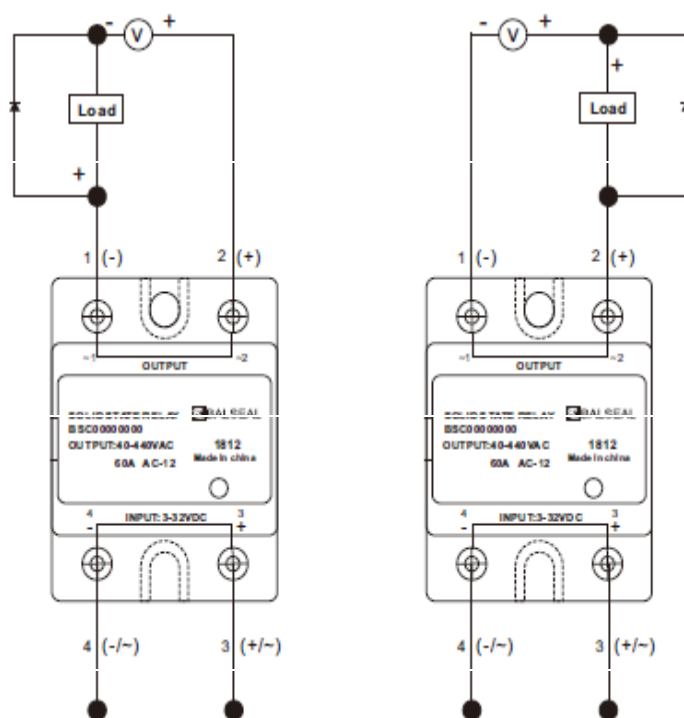

Matters needing attention

- all parameters at 25 C, unless otherwise specified.
- radiators must be installed for loads above 10A.
- fan or water cooling must be applied above 80 C

For more information, please contact us

Product certification

